

MODEL #: HDPT

## INSTALLATION AND REMOVAL PROCEDURES

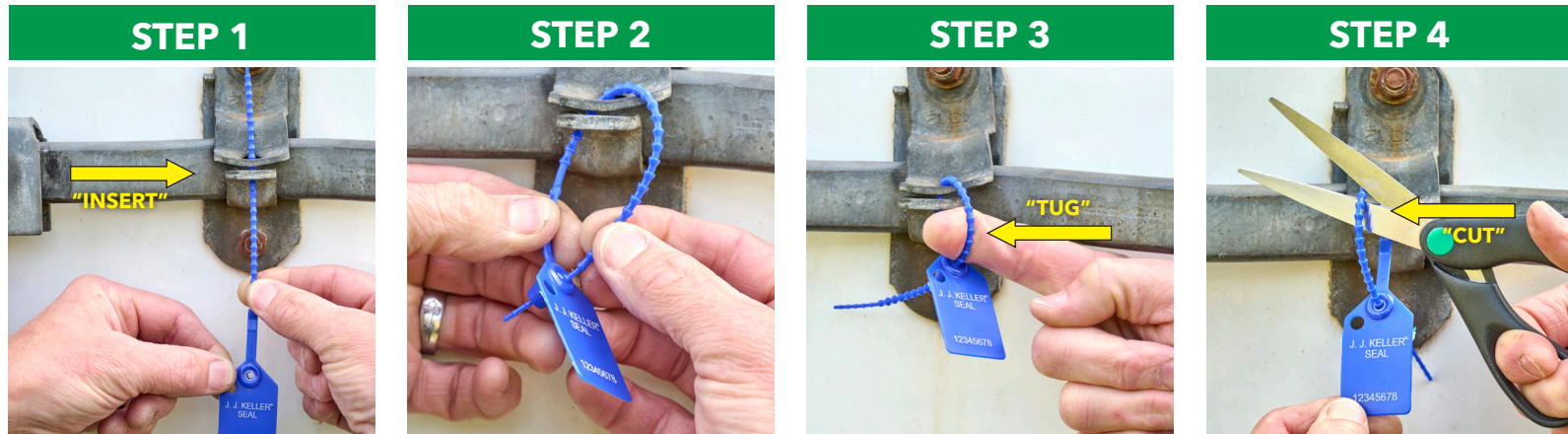

**STEP 1:** Feed the tail of the strap through the equipment locking hasp.

**STEP 2:** Insert the tip of the tail into the locking chamber until you feel it engage the locking teeth and hear a "click."

**STEP 3:** Tug on the seal to ensure it is locked.

**STEP 4:** To remove the seal, cut with a snipping tool (for example a scissors or snips) or remove it by hand by pulling forcefully on the strap.

## RECOMMENDED STORAGE & USE

- Store seals indoors in a climate-controlled area.
- Keep opened cartons of seals in a secure area with restricted access to only those that need to use the seals.
- Use seals in numerical order.
- Keep a log of seal usage (record seal numbers, users, and dates/times of when seals are installed and removed).